

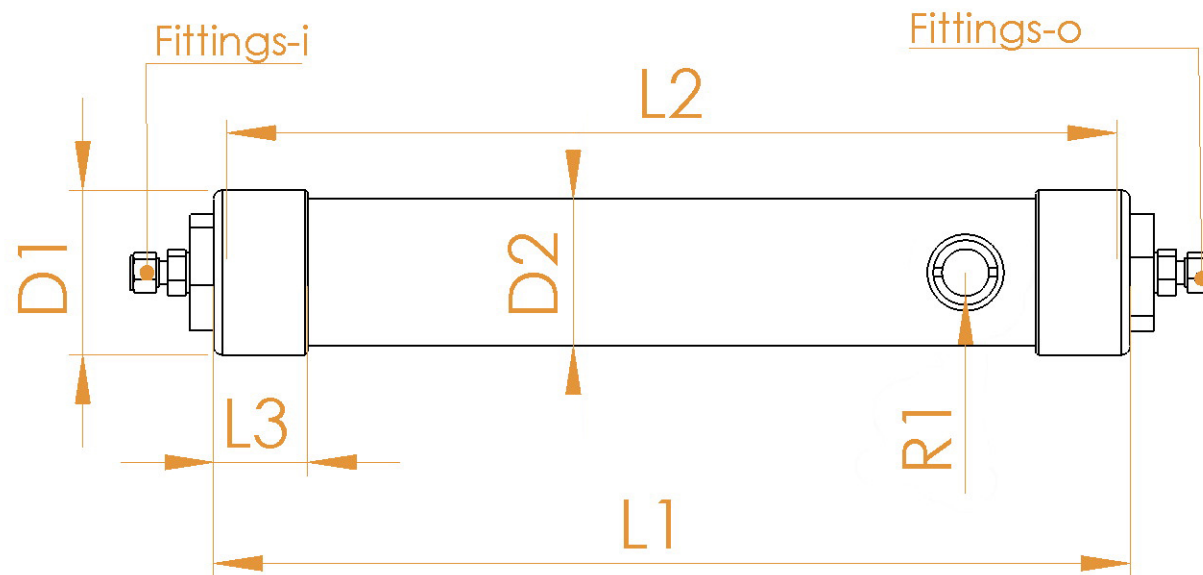

# SENH TYPE COLUMNS



## General Information

SENH Type Columns are for the adsorption of various gasses within a gas stream, can also be used to remove specific gas from gas stream such as  $H_2$ ,  $O_2$ ,  $H_2O$ ,  $HC$ ,  $CO_2$ ,  $CO$  etc. and provide a simple, low cost solution. All tube fittings are stainless steel, fitted with stainless steel frits for particulate control. The columns are empty. Maximum pressure is 40 bar. The column has an observation hole to check inside of the tube. Custom solutions are a cornerstone of our business model. If you have any interest in a custom solution. We are pleased to advise about any special applications you may have.

## Specifications

Outlet Gas Quality (%)	> 99.99
Maximum Pressure	40 bar
Maximum Temperature	100°C
Observation Hole Radius(R1)	8 mm
Usable For	All gas stream composition( $He$ , $H_2$ , $N_2$ , $Ar$ , $Air$ , $Hydrocarbons$ etc.)

## Applications

- Laboratory Equipment (GC/MS)
- Industrial Equipment (Gas Purification Systems, Compressed Air Systems)
- Welding Industry (Inert Welding/Brazing Systems)
- Defense Industry (Radar Waveguide Pressurization, Pneumatic Weapons)
- Semiconductor Industry
- Health Industry
- Food Industry





# SENH TYPE COLUMNS

## Ordering System

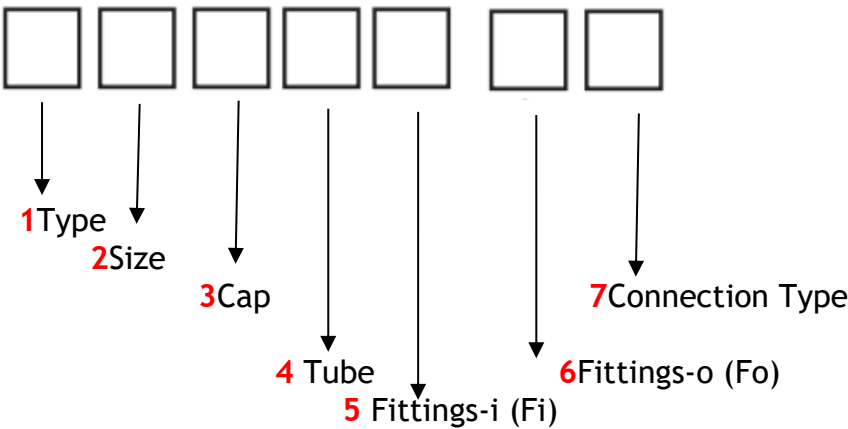

Example:

SENH Type Column, fittings are 1/4"and quick connection type, stainless steel tube, has stainless steel caps and the sizes are A.

→ Order: SENH - A - SS304 - SS304 -1/4 -1/4 - Q

## Size

mm	D1	D2	L1	L2	L3	Volume(L)	Flow Rate (mL/dk)	Maximum Flow Rate(SPLM)
A	36	30	220	180	35	0.1	135	2
B	48	40	260	220	35	0.2	135	2
C	58	50	370	330	35	0.5	200	2
D	68	60	480	440	35	1	265	2
E	88	80	370	330	35	1.5	200	2

\*\*\* The scale is mm.  
\*\*\* The metrics presented can easily change with customer needs and demands. Columns volumes up to 200 liters.

## Cap

Stainless Steel 304	SS304
Stainless Steel 314	SS314

## Tube

Stainless Steel 304	SS304
Stainless Steel 314	SS314

## Fittings Inlet - Outlet (Fi - Fo)

Inch System	Metric System
1- 1/2 - 1/4 - 1/8 ***The scale is "inch". Please contact with us for custom sizes.	3 - 4- 6- 8- 10- 12- 16- 20 ***The scale is "mm". Please contact with us for custom sizes.

## Connection Type

High Pressure Connection Type	P
Couplers	C
Quick Connection Type	Q

Üniversiteler Mh., İhsan  
Doğramacı Blv. No. 19  
Silikon Blok BK12/b ODTÜ-  
Teknokent, 06800,  
Çankaya/Ankara, Türkiye

info@yedic.co

Tel/Fax: +90 312 220 11 59

© 2018 Yedic Engineering rights reserved.